

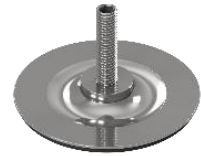

C-CLAW S300 for wind turbines



What is at Stake?

Wind turbines experience significant mechanical stress, and welding in the tower affects the structural integrity.

Despite this, 85% of the market chooses to weld inside wind turbines to attach ladders, cables, and other components. This means using **up to 100 tons** of additional steel per tower to compensate for the use of welding!

The remaining 15% of the market uses magnets instead, but these magnets are made of neodymium, a rare earth element that is **expensive** and difficult to procure.

Where can we help?

Cold Pad designed a bonded fastener as an alternative to welding, welded studs and screws that require **no drilling nor welding**: the C-CLAW S300.

C-CLAW allows to install equipment like pipe supports, handrails, ladders and more inside and outside wind turbines. They can hold up 300kg for up to 35 years indoors/20 years outdoors in marine conditions.

In 2024, Cold Pad received a Type Approval Certificate (TAC) for the C-CLAW S300 by Bureau Veritas.



What are the benefits for you?

Using our fastener for wind turbines will streamline the installation process: with just **30 seconds** and a user-friendly tool, you can install a C-CLAW S300.

It is also a cost-efficient option. There is no need for expensive magnets or extra steel to maintain structural integrity, as the C-CLAW is bonded - which makes it a non-intrusive device.